

Platte County Courthouse Remodel Phase I Project



Background

- The courthouse is in its 100th year of use and is in need of updates and space re-purposing to take us through another 100 years of serving Platte County.

Planning for the future

Original Scope

- Updates to utility systems
 - Electrical
 - Plumbing
 - HVAC
 - IT
- Maintenance of building exterior
- Courtroom security and space re-purposing in order to accommodate increased case loads and activity
- Provide additional Dispatch space and designed IT room (including designed HVAC)
- Building access [American Disability Act – (ADA)] improvement

Design Criteria

- Upgrade the facilities
 - Standard upgrade – not Taj Mahal
- Affordable cost
- Do not add OPEX to the County budget

Process with Original Scope

- Engage a structural engineer to evaluate the condition of the building and foundation
 - This evaluation confirmed the building and foundation are sound
- Engage an architect to develop space re-purposing options and cost estimates
 - Cost estimates verified by independent private contractor with experience related to renovation of older structures
- Evaluate cost estimates

Develop Alternate Approach (Phasing)

- Estimated cost of the entire project (~ \$14 MM) led to a phased approach, addressing primarily the ground floor in Phase I (\$ 4.875 MM)
- Utility Upgrades on first and second floors are not included in Phase I
- Phase I Scope
- ~~Updates to utility systems~~
 - ~~— Electrical~~
 - ~~— Plumbing~~
 - ~~— HVAC~~
 - ~~– IT~~
- ~~Maintenance of building exterior~~
- Courtroom security and space re-purposing in order to accommodate increased case loads
- Provide additional Dispatch space and designed IT room (including designed HVAC)
- Building access [American Disability Act – (ADA)] improvement

Remodel Phase I Specifics

- Work only on the ground floor
 - Eliminates the expense of government relocation
- Convert the unused six cell jail into a Circuit Courtroom with judges chambers, prisoner segregation, jury room and restrooms
- Install a new elevator with access from the front of the building
 - Remove the existing elevator
- Construct a new Dispatch and IT hub on the N side of the current detention facility
- Phased approach – Phase I must stand alone and not depend on future phases to be beneficial

General Limits of Work (Ground Floor)

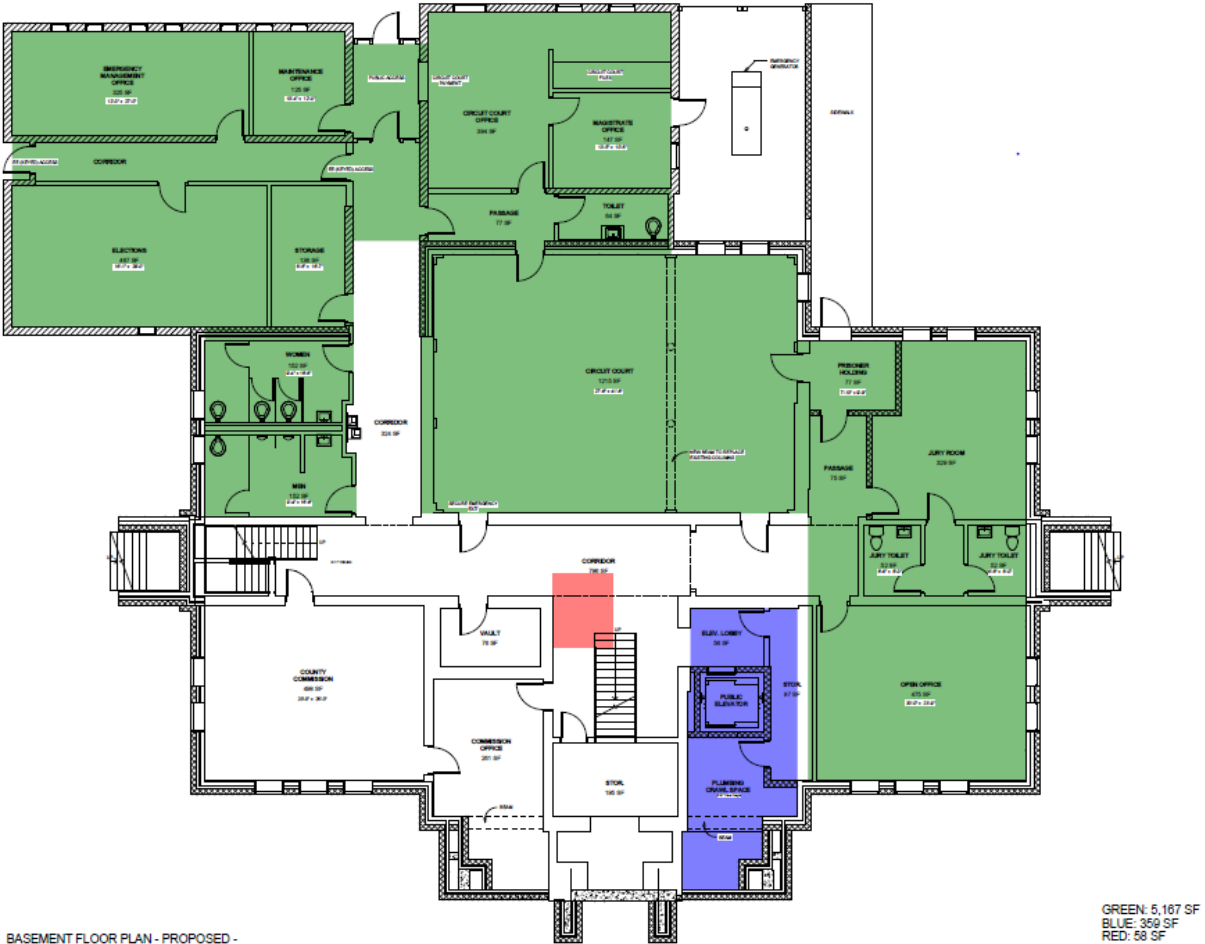

BASEMENT FLOOR PLAN - PROPOSED -
 PLATTE COUNTY COURTHOUSE

Remodel Phase I

Estimated Cost

- Components for total cost include
 - Ground Floor remodel for Circuit Court plus new elevator and access
 - Relocation of Dispatch and IT to the Detention Center “lean-to”
 - Finance cost

Cost in \$ MM			
Remodel		3.500	
Dispatch		0.600	
Subtotal		4.100	
Cost of \$		0.775	
TOTAL		4.875	

County Courts Case Load

District Court Cases

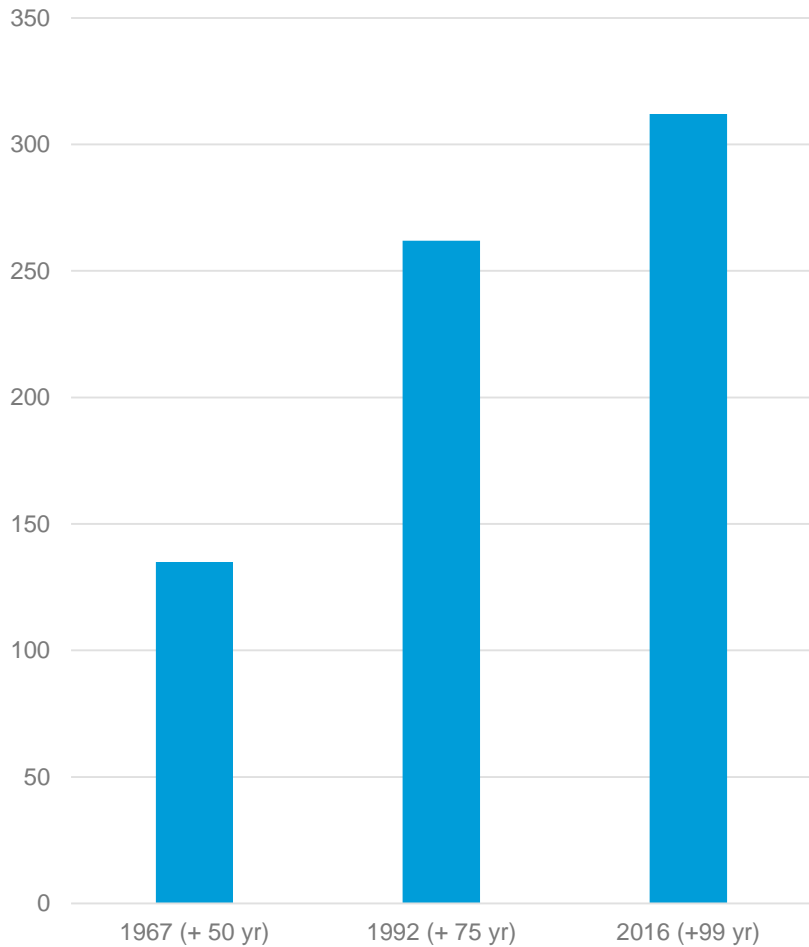

Circuit Court cases

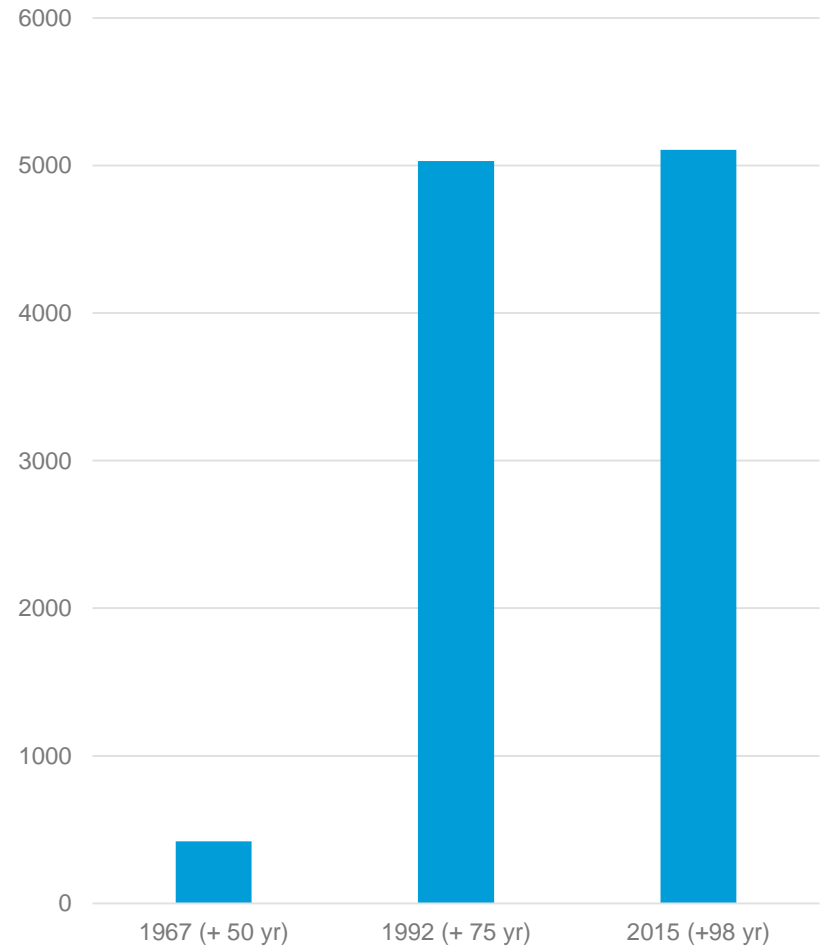

Courts

- For many of these cases, at least 2 to 3 hearings are required
- At times, Circuit Court is held in the Jury Room or the Commissioner Room
 - Alternate sites place an additional strain on Law Enforcement for public safety and security
 - Mass Arraignments – defendants within arms reach of judge
 - Defendants wait for their hearing in the hallway outside the courtroom shackled and with a deputy
 - Judges have to pass the waiting defendants to enter the alternate sites
- Attorney – client meetings are often held in any available space. When client is incarcerated, this requires additional presence of law enforcement personnel outside the meeting space.

Details of Remodel Scope Circuit Court

- The proposed Circuit Courtroom is the old six cell jail's current location
 - This space is currently used for storage
- Circuit Court staff office space with security features
- Designed accused segregation
- Jury Room and public toilet facilities



Details of Remodel Scope Dispatch



① 3D VIEW - NORTHEAST HIGH VIEW



② 3D VIEW - NORTHEAST LOW VIEW

Dispatch / IT 'lean-to'

- Provides space for third Dispatch console
- Relocates Dispatch adjacent to 24 / 7 law enforcement support
- Provides for designed IT space with room for expansion
- Includes designed HVAC for the IT equipment
- Space not prone to water hazard
- Facilitates seamless service
 - Ability to move a portion of the equipment into the new facility and test its operation before moving the remainder of the equipment over

Details of Remodel Scope Accessibility (Front Elevation)

Existing



Proposed



Accessibility

- Provides for ADA access from the front of the building
 - Current access is from the rear alley
 - Better parking for those requiring access

Plan for the Future

- Improvements made with fiscal responsibility
 - Improved courtroom safety and security
 - Dispatch center capacity for peak events
 - IT hub designed for future developments
 - Building accessibility improved
 - No new Operating Expense
-
- Funded through continuation of current 6th penny sales tax
 - Tax expires when project is complete
-
- Providing for the face of Platte County for the next 100 years